

Heritage Homes with luxury and style

CHANDRA Heritage



LUXURIOUS 2 BEDROOM APARTMENTS AT DABOLIM - GOA

A Project by



Location (not to scale)



CHANDRA
Heritage



For bookings & enquiries please contact

CHANDRA
CONSTRUCTIONS

34, TUKARAM KUNJ, ALTO DABOLIM GOA.
MR. PRAVEEN - 9225905550
9689160125 / 9764856830 / 9822486672
E mail: chandraconstructions@ymail.com

CENTRAL
DESIGN

All illustrations are artist impressions only. All landscaping features are subject to local authorities approval. The information contained in this brochure is subject to change as may be required by the authorities or the company and cannot form part of an offer or contract. All measurements are approximate. While every reasonable care is taken in providing this information, the developers cannot be held responsible for any inaccuracy.

CHANDRA Heritage

A scheme of comfortable well laid out two bedroom apartments, CHANDRA HERITAGE is situated at Dabolim, Goa.

Ideally located allowing you easy access to major cities in Goa and just a 10 minute drive from Vasco city. The homes are a short distance from Bogmalo & Hollant beaches, Dabolim International Airport and Railway station.

Educational and medical institutions like MES college and Vivus(SMRC) Hospital are also in the vicinity.

Designed and executed to provide maximum customer satisfaction CHANDRA HERITAGE fulfill your dreams of having a perfect home for you and your family.

Proximity to Bogmalo beach & The International Airport



A LIFE OF LUXURY & COMFORT

AMENITIES

- 4 passenger elevator with backup generator
- Club House with gym
- Intercom facility
- Covered car parking in stilts
- Underground and overhead water tank for ample water
- Compound wall on all sides with 24 hrs security
- Wide paved internal roads
- Wide entrance lobby

WITH PREMIUM SPECIFICATIONS

FLOORING: Vitrified flooring in living & dining and Ceramic tiles in other rooms.

DOORS: Teakwood main door with night latch and brass fixtures. Granite sill for main door. Designer flush doors for internal doors. FRP toilet doors.

WINDOWS: Powder coated aluminium sliding windows. Grills and Marble sills for windows

KITCHEN: Granite kitchen platform with SS sink

TOILET: Branded bathroom fixtures. Hot and cold system in both toilets. Designer tiles in toilets.

ELECTRICAL: Three phase electrical connection. Branded modular switches. AC/TV/Telephone points inside the apartments. Concealed copper wiring.



STILT FLOOR PLAN



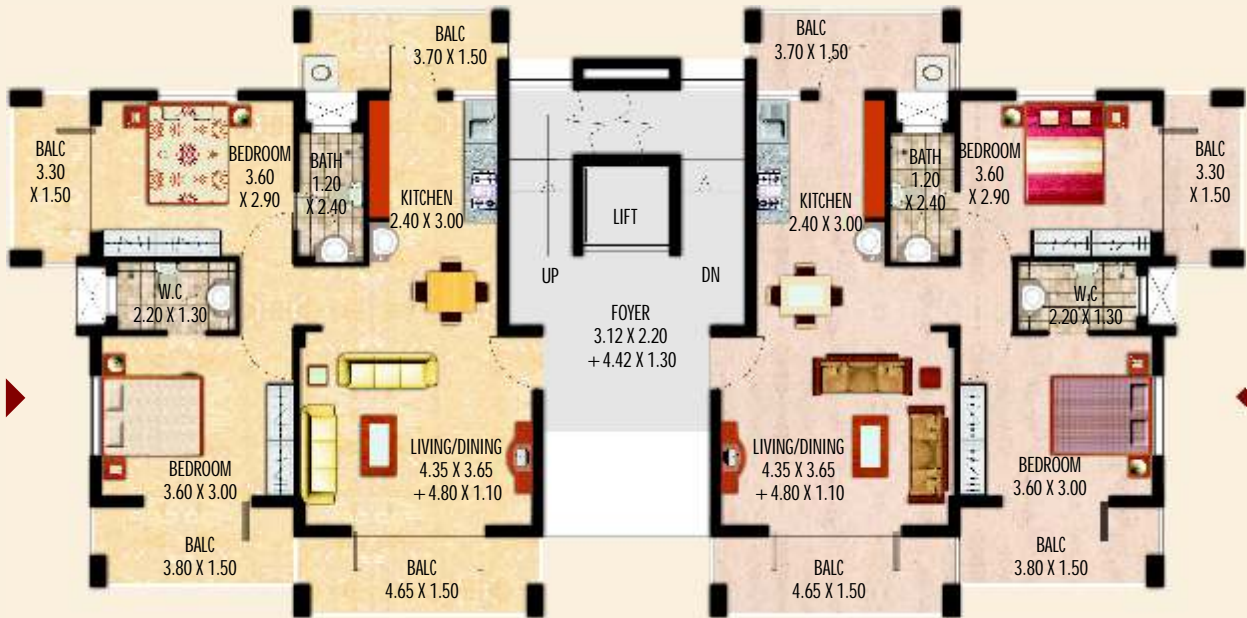

TYPICAL UPPER GROUND, FIRST & SECOND FLOOR PLAN

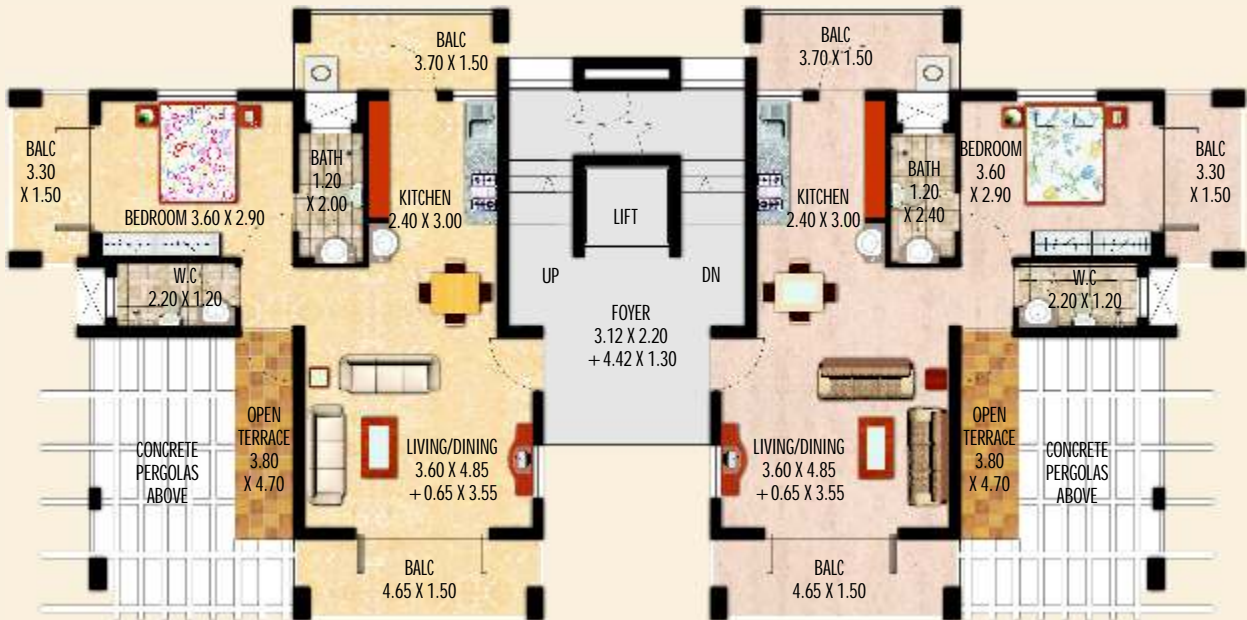

THIRD FLOOR PLAN (penthouse level 1)

(Including value additions)

(Including value additions)

Flat no
301

Flat no
302



ATTIC FLOOR PLAN (penthouse attic level)